

GRADUATE CONFERENCE INFORMATION

VENUE

Faculty of Arts and Social Sciences
National University of Singapore, Kent Ridge Campus
AS7 Shaw Foundation Building, 5 Arts Link, Singapore 117570

REGISTRATION COUNTER SECRETARIAT, AS7 FOYER

Please collect your conference kit and name badge at the Registration Counter.
The badge must be worn at all times to gain entry to sessions and functions.

Please check the Message Boards regularly for updates or announcements.
Messages for fellow delegates may be posted there.

SESSION ETIQUETTE

As a courtesy to the presenters and participants, please switch off (or put on silent mode) all beeping devices (mobile phones, etc.) during all sessions.

GRADUATE CONFERENCE SITE PLAN

| | |
|----------------------------------|--|
| Keynote/Plenary/Closing Sessions | AS7, Level 1, Rooms 01-16/17/18 (Room ABC) |
| Breakout Sessions | AS7, Level 1, Room ABC AS7, Level 1, Room 01-19 AS7, Level 1, Room 01-01 AS7, Level 1, Room 01-07 |
| Secretariat /Internet Stations | AS7, Foyer |
| Tea-Breaks | AS7, Foyer |
| Book Displays | AS7, Foyer |

AS7, SHAW FOUNDATION BUILDING, LEVEL 1

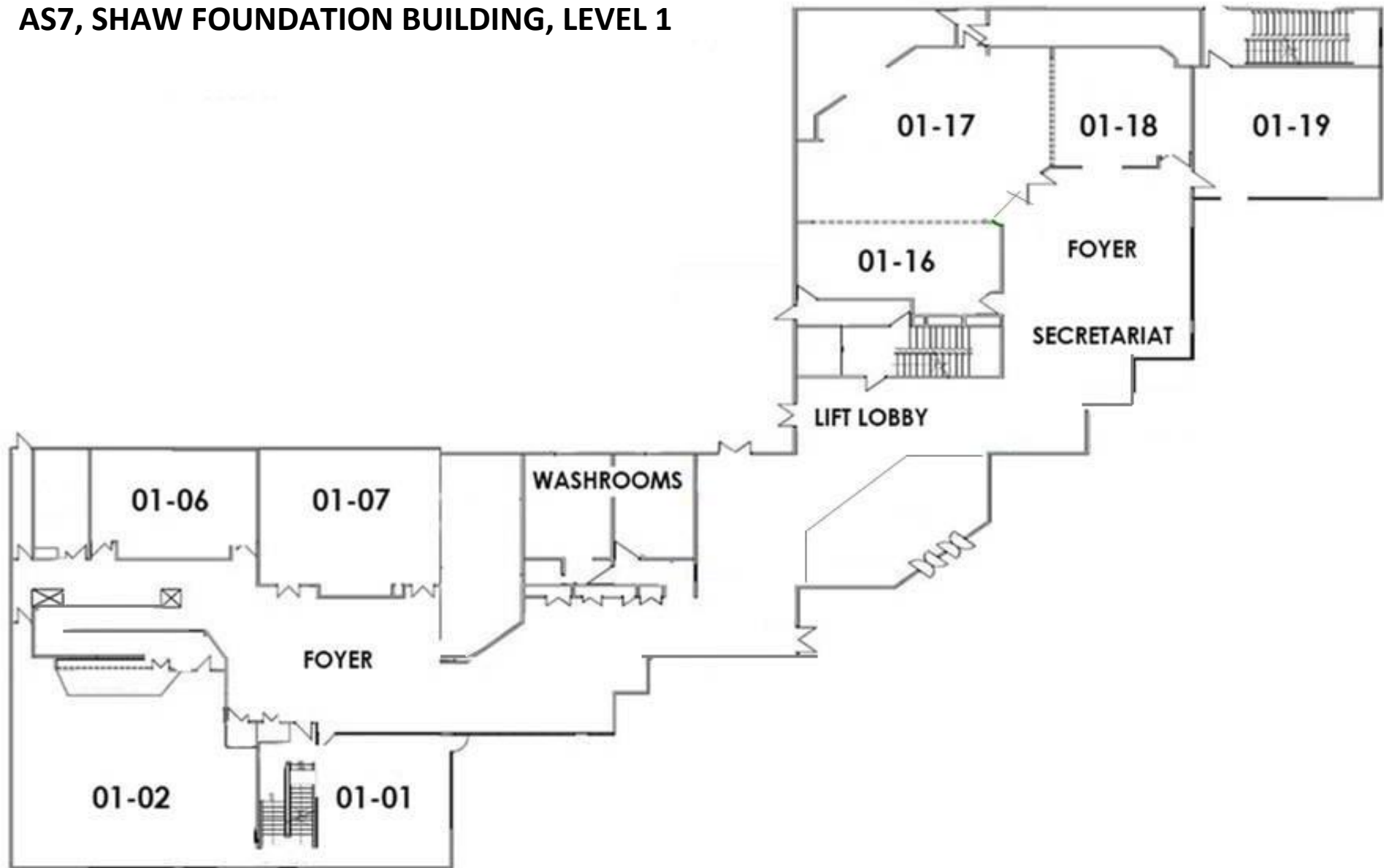

| MONDAY, 1 JULY 2013 | | | |
|---------------------|---|---|---|
| 09:00 – 09:30 | REGISTRATION (AS7 FOYER, LEVEL 1) | | |
| 09:30 – 09:45 | OPENING ADDRESS (ROOM ABC) | | |
| | <p>Professor Chua Beng Huat <i>Provost Professor, Head of Department of Sociology, Cluster Leader of Cultural Studies in Asia, Asia Research Institute, National University of Singapore, and Inter-Asia Cultural Studies Society</i></p> | | |
| 09:45 – 10:45 | KEYNOTE ADDRESS (ROOM ABC) | | |
| | <p>INTER-REFERENCING SOUTHEAST ASIA: FROM MIMICRY TO RESONANCE</p> <p>Professor Chua Beng Huat <i>Provost Professor, Head of Department of Sociology, Cluster Leader of Cultural Studies in Asia, Asia Research Institute, National University of Singapore, and Inter-Asia Cultural Studies Society</i></p> <p><i>Chairperson</i> Associate Professor Daniel Goh <i>Department of Sociology, National University of Singapore, and Inter-Asia Cultural Studies Society</i></p> | | |
| 10:45 – 11:15 | TEA BREAK | | |
| 11:15 – 12:30 | PANEL SESSIONS | | |
| | <p>ROOM ABC PANEL 1 QUEER THEORY I</p> <p><i>Chairperson</i> Keren Yi</p> | <p>ROOM 01-19 PANEL 2 HOME, WOMEN & FAMILY</p> <p><i>Chairperson</i> Jasnea Sharma</p> | <p>ROOM 01-01 PANEL 3 IDENTITY & SPATIAL CONSTRUCTS I</p> <p><i>Chairperson</i> Ji Youn Kim</p> |
| 11:15 | <p>Heteronormalizing a Queered Chanel in Online Chinese Fan Communities</p> <p>Jing Zhao <i>University of Wisconsin, USA</i></p> | <p>Understanding the Pain of Separation of Mass Migration: A Gender Analysis of <i>Bidesia</i> Songs</p> <p>Asha Singh <i>Tata Institute of Social Sciences - Mumbai, India</i></p> | <p>What Does it Mean to Preserve Age-old Traditions? Focusing on the Old Restaurants on <i>Pimaguil</i></p> <p>Soo Young Yang <i>Seoul National University, South Korea</i></p> |
| 11:30 | <p>An Other Othered By Other Others: Manila Luzon and the Irreverence of Drag</p> <p>Ma. Paula Luz M. Pamintuan-Riva <i>University of the Philippines – Baguio</i></p> | <p>Privacy, Gender and Space: A Study on Iranian Women's Privacy at Houses</p> <p>Mohammad Nouri <i>National University of Singapore</i></p> | <p>City, Space and the Informal Survivalism: The Study of Street Vendors in Dhaka City</p> <p>Md. Tarek Khan <i>University of Dhaka, Bangladesh</i></p> |
| 11:45 | <p>Online Comrade Literature from Mainland China: Communicating Messages to Subvert Repressive Heteronormative Ideologies of Gender and Sexuality on the Chinese Cyberspace</p> <p>Rachel Leng <i>Duke University, USA</i></p> | <p>Toward a Promising Family Future—The Question of Gender Equality Policy in Contemporary Taiwan</p> <p>Li-Fang Lai <i>National Central University, Taiwan</i></p> | <p>“Invited” Muslim Community in Korea and Afterwards</p> <p>Ji Youn Kim <i>National University of Singapore</i></p> |
| 12:00 | <p>Somewhere, Between ‘In’ and ‘Out’: (Self)Representing Queerness Using Online Social Media in Neoliberal China</p> <p>Keren Yi <i>The University of Melbourne, Australia</i></p> | <p>State, Borders, Home and Identity: An Asian Perspective</p> <p>Jasnea Sharma <i>National Chengchi University, Taiwan</i></p> | |
| 12:15 | QUESTIONS & ANSWERS | | |
| 12:30 – 13:45 | LUNCH | | |

| MONDAY, 1 JULY 2013 | | | |
|---------------------|---|---|--|
| 13:45 – 15:00 | PANEL SESSIONS | | |
| | ROOM ABC PANEL 4 QUEER THEORY II | ROOM 01-19 PANEL 5 GENDER – FILM | ROOM 01-01 PANEL 6 IDENTITY & SPATIAL CONSTRUCTS II |
| | Chairperson Wen-Ling Kung | Chairperson Ziquan Ni | Chairperson Kathleen Azali |
| 13:45 | Queer Romance in South Korea Junan Jang <i>Korea National University of Arts, South Korea</i> | Islamic Masculinity in Indonesian Islamic Movies (The Representation of Men and the Practice of Men's Power in Indonesian Islamic Movies in the Post New Order Period) Muria Endah Sokowati <i>Gadjah Mada University, Indonesia</i> | From Africa to China: An Exploration of Place-making Practices and Structures of Belonging amongst Africans in Guangzhou Roberto Castillo <i>Lingnan University, Hong Kong</i> |
| 14:00 | 'We Are All Different, There Are No Differences' — The Discourse of Sexual Diversity in Contemporary Japan Shu Min Yuen <i>The University of Melbourne, Australia</i> | New Malaysian Femininity: Redefining Malay Womanhood in Yasmin Ahmad's Films Humairah Bte Zainal <i>National University of Singapore</i> | 'Fair Travel' as a Global Justice Movement Jiyoan Kim <i>The University of Tokyo, Japan</i> |
| 14:15 | "Born This Way/Gay?" Chinese Queer Liberalism and Homosexual Biopolitics Yuinting Ong <i>The Chinese University of Hong Kong</i> | Women's Gender Roles in Contemporary Thai Romantic Comedy Films Kanakkorn Witedwittayanusat <i>Nanyang Technological University, Singapore</i> | Biopolitics in Japanese Railway Stations: The Significance of Gates, Escalators and Manner Posters Kaima Negishi <i>The Australian National University</i> |
| 14:30 | The Representations of LGBT Spatial Politics in Two Taiwanese "Tongzhi" Films— From Crystal Boys (1986) to Formula 17 (2004) Wen-Ling Kung <i>Academia Sinica, Taiwan</i> | Female Masculinity in King Hu's <i>A Touch of Zen</i> Ziquan Ni <i>The Chinese University of Hong Kong</i> | Potentials and Challenges of Alternative Space Kathleen Azali <i>University of Airlangga, Indonesia</i> |
| 14:45 | QUESTIONS & ANSWERS | | |
| 15:00 – 15:15 | BREAK | | |

| MONDAY, 1 JULY 2013 | | | |
|---------------------|---|---|--|
| 15:15 – 16:15 | PANEL SESSIONS | | |
| | ROOM ABC PANEL 7 CULTURAL IDENTITY – LITERATURE & FILM I | ROOM 01-19 PANEL 8 CULTURAL POLICY, ARTS & GOVERNMENT | ROOM 01-01 PANEL 9 WAR & MEMORY – TV & FILM |
| | <i>Chairperson</i> Maria Myutel | <i>Chairperson</i> Tobias Zuser | <i>Chairperson</i> Satoko Kakahara |
| 15:15 | Reinterpreting the 80-90s Hong Kong “Geung Si” Films (Jiang Shi Dian Ying) in Postcolonial Context Mandy Yee Man Liu <i>Lingnan University, Hong Kong</i> | <i>When Heaven Burns, When Censorship</i> Backfires: A Case Study of Audience Subversion and Submission Jui Liang Sim <i>Nanyang Technological University,</i> <i>Singapore</i> | The Wartime Memory and Women’s Representation in Japan: From the Analysis of NHK Morning Television Series “Asadora” Vicky Hsin-Yi Huang <i>Doshisha University, Japan</i> |
| 15:30 | Trashy Horror vs. Popular Piety: What Makes ‘Good’ National Cinema? Meghan Downes <i>The Australian National University</i> | Across the City, Toward the Nation: Train as Site of Poetry, Poetry as Site of the Train Oscar Tanoco Seruiña Jr <i>University of the Philippines – Diliman</i> | Memory and Nation in Chinese and Japanese Trial Films Amanda Weiss <i>The University of Tokyo, Japan</i> |
| 15:45 | Indians and Soap Opera in Indonesia: Behind <i>The Seen</i> Maria Myutel <i>The Australian National University</i> | Boundaries of Cultural Space: “Hidden Agenda” in Hong Kong’s Cultural Policy and Urban Redevelopment Tobias Zuser <i>Lingnan University, Hong Kong</i> | Love and Lie in Family Drama: Forced Intimacies and Neoimperialism Satoko Kakahara <i>University of California – San Diego, USA</i> |
| 16:00 | QUESTIONS & ANSWERS | | |
| 16:15 – 16:30 | BREAK | | |

MONDAY, 1 JULY 2013

| 16:30 – 17:45 | PANEL SESSIONS | | | |
|---------------|--|--|---|--|
| | ROOM ABC PANEL 10 CULTURAL IDENTITY – LITERATURE & FILM II | ROOM 01-19 PANEL 11 POPULAR CULTURE | ROOM 01-01 PANEL 12 RELIGION | ROOM 01-07 PANEL 13 LABOUR |
| | Chairperson Jose Mari Cuartero | Chairperson Mateja Kovacic | Chairperson Jay Lai Ieng Lau | Chairperson Minjoo Lee |
| 16:30 | Laughter, Spatial Practice and Politics in Hong Kong Comedy Films Ray Kwok Wai Lai <i>The Chinese University of Hong Kong</i> | Yaoi and Boys Love in Southeast Asia: A Case Study on the Emergence of a Global Subculture of Resistance to Patriarchal and Heteronormative Social Orders Tricia Abigail Santos Fermin <i>Osaka University, Japan</i> | Revisiting Hong Kong Cultural Pluralism: The Case of Sheungshui Mosque Developing Process Login Lok-Yin Law <i>Hong Kong Baptist University, and The Chinese University of Hong Kong</i> | Financialization and Imaginaries Emanating from “Financial Literature” in Shanghai Giulia Dal Maso <i>University of Western Sydney, Australia</i> |
| 16:45 | Are They Finnishness or Japaneseness?: A Discourse Analysis of Criticisms of Aki Kaurismäki’s Films in Japanese Media Rie Fuse <i>University of Tampere, Finland</i> | Where the Violent Things are: Cultural History of Japanese Rock Crowds Sota Takahashi <i>Tokyo University of the Arts, Japan</i> | Tourism as Spiritual Warfare: Rethinking Global Pentecostalism with Short- term Mission Trips by Cell Church Mission Network in Hong Kong Jay Lai Ieng Lau <i>Lingnan University, Hong Kong</i> | Appearance as a Competence: Focusing on Appearance Management Practice Steffie Yeonjoo Kim <i>Seoul National University, South Korea</i> |
| 17:00 | Affect and Asian Identity Politics: Exploring Affect’s Potency in Arundhati Roy’s <i>The God of Small Things</i> Jose Mari Cuartero <i>University of the Philippines – Diliman, and Ateneo De Manila University, Philippines</i> | What is Resistance? Looking at Tokyo’s Contemporary Punk Culture Haruka Iharada <i>Tokyo University of the Arts, Japan</i> | | Return to Proletariat or Invention of another Political Subjectivity?: New Cultural Politics of Non-labor Subjects in Japan since Late 1990s Minjoo Lee <i>The University of Tokyo, Japan</i> |
| 17:15 | | Imaginary Worlds of Japanese Anime Mateja Kovacic <i>Hong Kong Baptist University</i> | | |
| 17:30 | QUESTIONS & ANSWERS | | | |
| 17:45 | END OF DAY ONE | | | |

| TUESDAY, 2 JULY 2013 | | | |
|----------------------|---|---|--|
| 09:15 – 09:30 | REGISTRATION (AS7 FOYER, LEVEL 1) | | |
| 09:30 – 10:30 | PANEL SESSIONS | | |
| | ROOM ABC PANEL 14 ARTS CRITIQUE & POLITICS <i>Chairperson</i> Bernadette Ryan | ROOM 01-19 PANEL 15 IDENTITY – FILM & TV <i>Chairperson</i> M. Regina Widhiasti | ROOM 01-01 PANEL 16 CYBERSPACE & POLITICS <i>Chairperson</i> Ryosuke Hidaka |
| 09:30 | <i>“Shuhari” – What is the Japanese Sense of Tradition? A Heretic Goshu Ondo Singer during the “World Music” Boom</i> Ai Fujimoto <i>Tokyo University of the Arts, Japan</i> | <i>“Pure-Love” and Transnationality: Examining Post-Millennium Japanese “Pure-Love” Films</i> I-Te Rita Sung <i>State University of New York at Stony Brook, USA</i> | <i>Away in the Philippines – Development of Cyber Customary Practices on Interpersonal Conflicts within the Framework of the Philippine Political System</i> Teresa Paula S. De Luna <i>University of the Philippines – Diliman</i> |
| 09:45 | <i>History, Identity and Political Culture: The Imagination of Space in Post-1997 Hong Kong Films</i> Dan Shen <i>Lingnan University, Hong Kong</i> | <i>Television as Dispositif: Contemporary Chinese Women, Urbanity and Chinese Entertainment Television</i> Xuenan Cao <i>Hong Kong Baptist University</i> | <i>CCTV for Censorship, Control, Television and Vendetta? How the State-run Television Shocked Chinese Spectators</i> Gabriele de Seta <i>The Hong Kong Polytechnic University</i> Dino Cheung <i>The Hong Kong Polytechnic University</i> |
| 10:00 | <i>Creative Australia: Insights into Creativity and Thai phleng phuea chiwit Music</i> Bernadette Ryan <i>Central Queensland University, Australia</i> | <i>Becoming a Queen in Your Kitchen: Idealizing Modern Indonesian Women</i> M. Regina Widhiasti <i>Universitas Indonesia</i> | <i>How Japanese Desk Top Music Culture was Brought under Control</i> Ryosuke Hidaka <i>Tokyo University of the Arts, Japan</i> |
| 10:15 | QUESTIONS & ANSWERS | | |
| 10:30 – 11:00 | TEA BREAK | | |

| TUESDAY, 2 JULY 2013 | | | |
|----------------------|--|---|--|
| 11:00 – 12:00 | PANEL SESSIONS | | |
| | ROOM ABC PANEL 17 AN EAST ASIAN IMAGINARY I | ROOM 01-19 PANEL 18 MIGRATION I | ROOM 01-01 PANEL 19 MEMORY & VIOLENCE IN MEDIA |
| | Chairperson Anneke Coppoolse | Chairperson Carol Chan | Chairperson Pei Jean Chen |
| 11:00 | Supranational Identity Formation in Government Elites through Regional Institution-Building: Proposal for Future Research on East Asian Regionalism José Guerra Vio <i>National Chengchi University, Taiwan</i> | Migration Strategy and Organization of Transnational Spaces: A Case Study of Indonesian Migrant Workers in Korea You Il Sang <i>Hanyang University, South Korea</i> | Shrieks of Silence: Reconstruction of the Kumher Massacre of 1992 Ridhima Sharma <i>Tata Institute of Social Sciences – Mumbai, India</i> |
| 11:15 | Performative Subjects outside the State: Jiang Wen's "Devils on the Doorstep" Xiangjing Chen <i>Cornell University, USA</i> | Situating 'Development' in the Migration-Development Nexus: The Perspectives of Non-Migrants and Return Migrants in Asia Carol Chan <i>University of Pittsburgh, USA</i> | The Memories of a Spark: Reconstructing the 1965 Riots in Madurai against the Imposition of Hindi Sriram Mohan <i>Tata Institute of Social Sciences – Mumbai, India</i> |
| 11:30 | Being On Foot: How Pedestrian Mobility in Transnational Hong Kong and Shenzhen Shapes Places and Defines Identities Anneke Coppoolse <i>Lingnan University, Hong Kong</i> | | Examining Colonial Governmentality of Sexuality through the Lens of Female Same-Sex Suicide in 1920-30s' East Asia Pei Jean Chen <i>Cornell University, USA</i> |
| 11:45 | QUESTIONS & ANSWERS | | |
| 12:00 – 13:30 | LUNCH | | |

| TUESDAY, 2 JULY 2013 | | | |
|----------------------|---|---|---|
| 13:30 – 14:45 | PANEL SESSIONS | | |
| | ROOM ABC PANEL 20 AN EAST ASIAN IMAGINARY II | ROOM 01-19 PANEL 21 MIGRATION II | ROOM 01-01 PANEL 22 CULTURAL SIGNIFIERS & NATIONALISM I |
| | Chairperson Lulu Zhou Egret | Chairperson Jungmin Kwon | Chairperson Sisi Tang |
| 13:30 | The Multiple Dimensions of Audience Engagement: (Re)constructing a Shared Imagination of East Asia S.M. Geitty Tambunan <i>Lingnan University, Hong Kong</i> | Remittances as Form Paul Nadal <i>University of California – Berkeley, USA</i> | Formation and Reconstruction of Ethnic Boundaries between Russian and Kazakh Language Speakers (Case Study of Kazakhstan National University Student Groups) Julia Khan <i>Hanyang University, South Korea</i> |
| 13:45 | A Dream of SM Entertainment: Cultural Sub-imperialism, Developmentalism, and Financialization of KPOP Sangkyu Lee <i>Seoul National University, South Korea</i> Daemin Park <i>Seoul National University, South Korea</i> | Desire to be Modern: Taiwan and its Immigrant Penumbrae Kris Yu-Shiuan Chi <i>National Central University, Taiwan</i> | China's Modernist Ascendancy: At What Cost to "Traditional Culture"? Tung-Yi Kho <i>Lingnan University, Hong Kong</i> |
| 14:00 | Re-conceptualizing Fan-Celebrity Relationships and Re-negotiating Fan Identities: A Cultural Studies' Perspective Lulu Zhou Egret <i>The Chinese University of Hong Kong</i> | Imagined Japanese: The "Homecoming" Process of Mixed Heritage Japanese-Filipinos Megumi Hara <i>Osaka University, Japan</i> | Deciphering the Nationality Signifier through Desire and Recognition: The Multivalency of China/PRC-ness Peidong Yang <i>University of Oxford, UK</i> |
| 14:15 | | The Ethnography of Third Culture Kids: Experiences of Growing up in the US and Returning to Home Jungmin Kwon <i>Brown University, USA</i> | Confucius Institute: A Cultural Ambassador or a Political Propagandist? Sisi Tang <i>National Chengchi University, Taiwan</i> |
| 14:30 | QUESTIONS & ANSWERS | | |
| 14:45 – 15:00 | BREAK | | |

| TUESDAY, 2 JULY 2013 | | | |
|----------------------|---|--|---|
| 15:00 – 16:15 | PANEL SESSIONS | | |
| | ROOM ABC PANEL 23 YOUTH CULTURE | ROOM 01-19 PANEL 24 CIVIL SOCIETY & SOCIAL TRANSFORMATION | ROOM 01-01 PANEL 25 CULTURAL SIGNIFIERS & NATIONALISM II |
| | Chairperson Malikova Nataliya | Chairperson Guoyuan Sun | Chairperson Roslynn Ruoh Theng Ang |
| 15:00 | Youths, Social Media and National Identity Lee Ken Teo <i>National University of Singapore</i> | The Return to Punitive Society? State of Juvenile Delinquency in the Philippines from 2006 to 2011 Jose Carlo Garcia De Pano <i>University of the Philippines – Diliman</i> | The Whiteness in East Asia Vincent Chung <i>National Taiwan Normal University</i> |
| 15:15 | Inseparable Usual Images: Reading Media Consumption and Cultural Identity in Indonesian Youth Artwork Evelyn Huang <i>Jakarta Institute of the Arts, Indonesia</i> Salima Hakim <i>Multimedia Nusantara University, Indonesia</i> | Visual Art, Collaboration and the Subaltern Felicia Ee Ping Low <i>National University of Singapore</i> | Beyond “China Factor”? — Rethink Democratic Identity in Taiwan and Hong Kong Ted Keng-Liang Cheng <i>Lingnan University, Hong Kong</i> |
| 15:30 | The Role of the Media in Redefining the Concept of Youth Subcultural Graduation: Analyzing Media Discourses around Senior Gyarū and Gyarū-o Who Do Not “Graduate” Yusuke Arai <i>Hitotsubashi University, Japan</i> | Imagination of an Alternative Social Transformation through Education: A Study of a Youth Volunteering Programme in the Non-formal Education Sector in China Guoyuan Sun <i>Lingnan University, Hong Kong</i> | Ainu Pride: Beyond a Reproduction of a Dichotomous Self Roslynn Ruoh Theng Ang <i>New York University, USA</i> |
| 15:45 | Ideologies and Their Oppositions among Youth Social Movements in Japan Malikova Nataliya <i>Hitotsubashi University, Japan</i> | | |
| 16:00 | QUESTIONS & ANSWERS | | |
| 16:15 – 16:30 | BREAK | | |

| TUESDAY, 2 JULY 2013 | |
|----------------------|--|
| 16:30 – 18:00 | PLENARY SESSION (SEMINAR ROOM ABC) |
| | <p>CULTURAL STUDIES IN ASIA: CONTESTATIONS AND CHALLENGES IN A GLOBALIZED WORLD</p> <p>Chairperson</p> <p>Professor Kuan-Hsing Chen <i>Professor of Graduate Institute for Social Research and Cultural Studies, Coordinator of Center for Asia-Pacific/ Cultural, National Chiao Tung University, Taiwan, and Inter-Asia Cultural Studies Society</i></p> <p>Panelists</p> <p>Professor Meaghan Morris <i>Chair, Inter-Asia Cultural Studies Society, and Professor of Gender and Cultural Studies, The University of Sydney, Australia, Distinguished Adjunct Professor, Department of Cultural Studies, Lingnan University, Hong Kong, Fellow of the Academy of the Humanities of Australia, and Fellow of the Hong Kong Academy of the Humanities</i></p> <p>Professor Melani Budianta <i>Professor of Literature, Faculty of Humanities, Universitas Indonesia</i></p> <p>Professor Ashish Rajadhyaksha <i>Senior Fellow, Centre for the Study of Culture and Society, India</i></p> <p>Professor Tejaswini Niranjana <i>Lead Researcher of Higher Education Innovation and Research Applications, Senior Fellow of Centre for the Study of Culture and Society, India, Visiting Professor of Tata Institute of Social Sciences – Mumbai, India, Advisor of Access to Knowledge Programme, The Centre for Internet and Society, India, and Visiting Faculty, Centre for Contemporary Studies, Indian Institute of Science, India</i></p> |
| 18:00 | CLOSING REMARKS |
| | <p>Associate Professor Daniel PS Goh <i>Department of Sociology, National University of Singapore, and Inter-Asia Cultural Studies Society</i></p> |
| 18:30 | END OF GRAUDATE CONFERENCE |
| 18:30 – 20:00 | GRADUATE CONFERENCE DINNER @ AS7 FOYER |

MAP OF CONFERENCE VENUE

AS7, Shaw Foundation Building, Faculty of Arts and Social Sciences
National University of Singapore (Kent Ridge Campus)

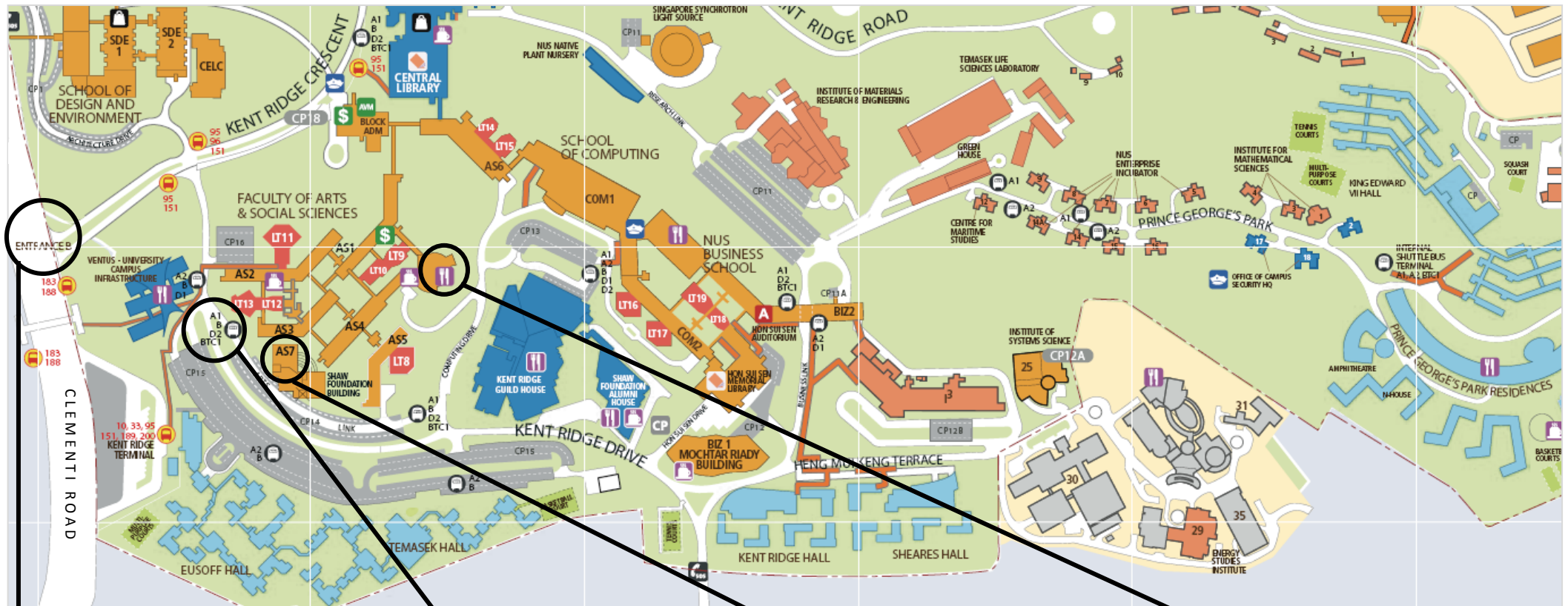

TRAVELLING BY TAXI

- Enter by **Entrance B** of NUS into Kent Ridge Crescent
- Turn right at the first traffic light into Kent Ridge Drive
- Turn left into the second Carpark #14 after the overhead bridge



NUS INTERNAL SHUTTLE BUS

A1, B, D2, BTC1

<http://www.nus.edu.sg/oed/services/transport/shuttle-bus-services.htm>



SHAW FOUNDATION BUILDING

AS7 Faculty Of Arts & Social Sciences
5 Arts Link Singapore 117570



FOOD OUTLETS

- The Deck Stalls @ Level 1
- Local Food, Snacks, Fruit Juices, Coffee & Tea
- The Deck Stalls @ Level 2
- Burger King
 - Sapore Italiano
 - Indonesian Express

NUS INTERNAL SHUTTLE BUS SERVICE "A" ROUTE

Service A2 (Blue) Prince George's Park Residences (PGP) → Faculty of Arts and Social Sciences (FASS)

Service A1 (Red) Faculty of Arts and Social Sciences (FASS) → Prince George's Park Residences (PGP)

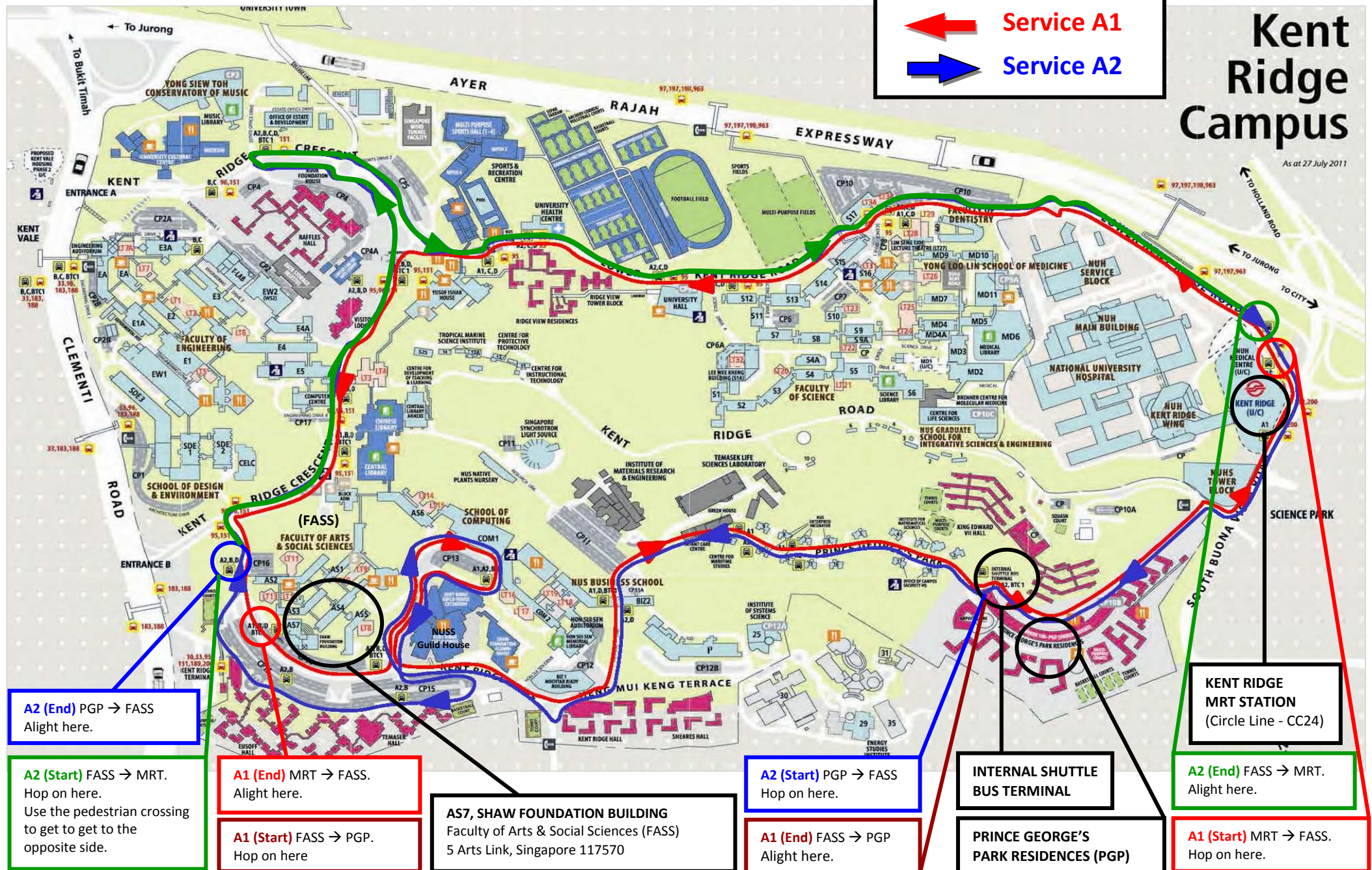

LOCAL INFORMATION

Currency Exchange

Singapore's currency is the Singapore dollar (S\$ or SGD). Money changing services can be found at Singapore Changi Airport, shopping centres and hotels around the island. There are also an abundance of automated teller machines (ATMs) which accept most major credit cards such as Visa, MasterCard and American Express.

Drinking Water

It is safe to drink water straight from the tap in Singapore. However, for those who prefer bottled mineral water, local supermarkets and grocers always have ample stock.

Electricity

Singapore voltage is 220-240 volts AC, 50 cycles per second. The power plugs used in Singapore are of the three-pin, square-shaped type.

Language

English is the language primarily spoken in Singapore. Mandarin, Malay and Tamil, together with other dialects, are used as well.

Mobile Phone

Singapore's international dialing code is +(65). While in Singapore and if you have international roaming service on your cell phone, you do not have to press +(65) as it will automatically connect you to the local numbers here. There are two mobile phone networks - GSM900 and GSM1800 - and three mobile telephone service providers - SingTel, M1 and StarHub.

Smoking

Smoking is prohibited in all airconditioned areas (e.g. shopping centres, restaurants, cinemas, public buses, the MRT, taxis, lifts), common corridors, void decks and staircases within residential buildings, outdoor hospital compounds, as well as a 5-metre radius from any entrance/exit and bus shelter.

Weather

Singapore is known for its hot and humid weather, with little variation throughout the year. The average daytime temperature is 31°C (88°F), dropping to around 24°C (75°F) in the evenings. The monsoon season can bear down pretty heavily on our tropical weather from November onwards, so be prepared for rain on a daily basis during this period.

Tax Refund Schemes

To enjoy tax-free shopping in Singapore, simply look out for retailers that display the "Tax Refund" logo on their shop front and spend SG100 in a single receipt to qualify. More information can be found at the Tourist Refund Scheme page on the Singapore Customs website at www.customs.gov.sg

Tipping

Tipping is not widely practiced in Singapore as most hotels and restaurants apply a default 10% service charge.

LOCAL INFORMATION

Transport

The public transport in Singapore is well connected with commuters able to choose between train, taxis and buses.

Mass Rapid Transport (MRT)

This is a fast and efficient form of transport, with a train arriving every few minutes. Fares range from S\$1.00 to S\$2.00, from vending machines at the stations. Operating hours vary a little but trains run from around 05:15 to 00:15. It is recommended to check what time the last train leaves from the respective stations if you are planning a late night.

Bus

Bus fares range from S\$1.00 to S\$2.00. If you are paying in cash, please ensure you have the correct fare, as bus drivers do not give change. Alternatively, you can purchase an Ez-Link card, which is a stored-value fare card, from bus interchanges and MRT stations. Ez-Link cards may be used for bus and MRT fares.

Taxi

Taxis can be flagged from hotels and taxi stands, as well as on the streets, if there are no taxi stands nearby and traffic is not disrupted. Flagged taxi fares starts between S\$3.00 and S\$3.40 for the first 1km. There are additional charges for trips from Changi Airport (from S\$5.00 onwards, depending on the time); to and fro from the Central Business District (S\$3.00 from Monday to Saturday, 17:00 to midnight), Peak Hours (25% of the metered fare on Monday to Saturday from 06:00-09:30 & 18:00 to midnight); After Midnight (50% of the metered fare shown). Advance booking numbers (booking surcharge varies from S\$8.00 to S\$18.00):

| | |
|----------------------|----------------|
| Comfort CityCab | (65) 6552 1111 |
| Comfort Premier Cabs | (65) 6552 2828 |
| SMRT Taxis | (65) 6555 8888 |
| Premier Taxis | (65) 6363 6888 |

Useful Telephone Numbers

| | |
|------------------------------------|---------------------------------|
| Police | 999 |
| Ambulance & Fire Brigade | 995 |
| Non-Emergency Ambulance Service | 1777 |
| Singapore Tourism Board | 1800-736 2000 |
| Postal Enquiries (SingPost) | 1605 |
| Local Directory Assistance | 100 |
| International Directory Assistance | 104 |
| Singapore General Hospital | (65) 6222 2322 / (65) 6234 4311 |
| Mount Elizabeth Hospital | (65) 6737 2666 |
| Gleneagles Hospital | (65) 6473 7222 |